

# Danalock Cylinder Adaptor Installation Guide

DCSLAE series

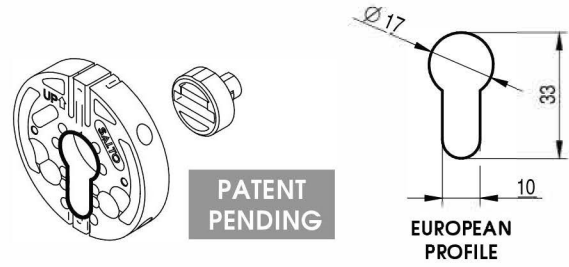

**TOOLS REQUIRED**

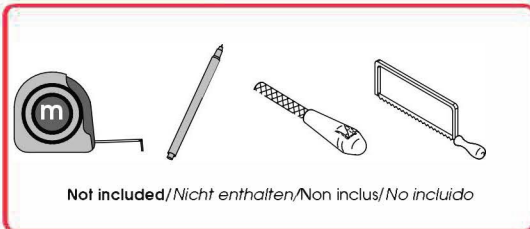
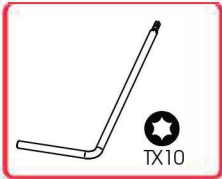

**!**

Only for Double clutch cylinders.  
Zylinder mit Gefahrenfunktion.  
Uniquement pour cylindres avec  
Panneau débrayable.  
Solo para cilindros doble  
embrague.

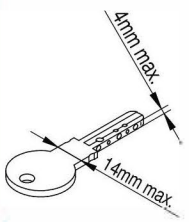

**!** **1**

On the inside of the door,  
the cylinder must protrude  
at least 3mm past the  
handleset or the escutcheon  
to allow the Danalock Cylinder  
Adaptor to be fitted correctly.

**2**

**3**

**3a**

**!**  
6±7 mm

**3b**

**3c**

**4**

**5**

**5a**

**5b**

Push!

**6**

**7**

**8**

**8a**

**!**

**8b**

click! **!**

9



9a

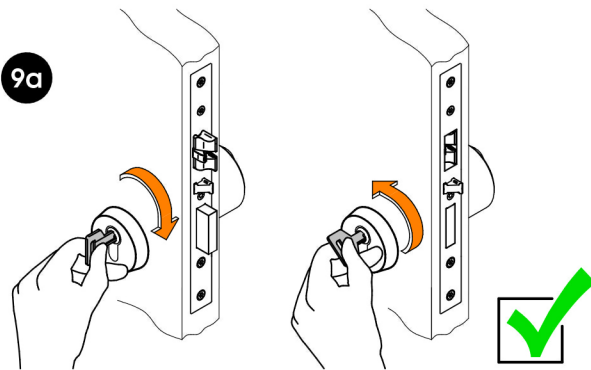

9b

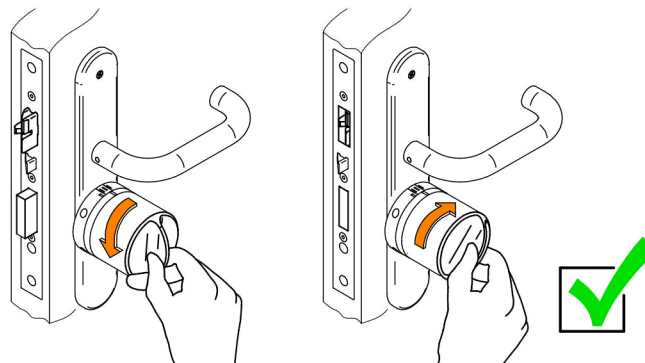

10

10a

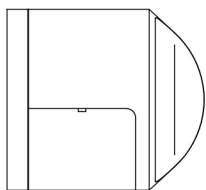

10b

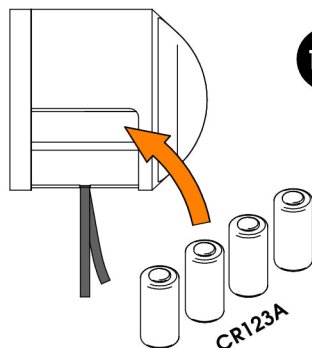

10c

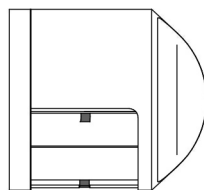

10d

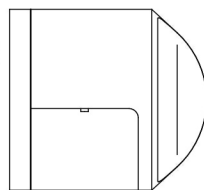

11

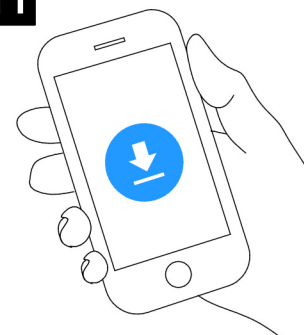

45 Assembly Street Edinburgh EH6 7BQ  
**Tel: 0131 555 0909** Fax: 0131 554 1177  
 Email: sales@keyprint.co.uk  
**Website: www.keyprint.co.uk**